

RF CHOKES - MOULDED

Dimensions in inches (mm)

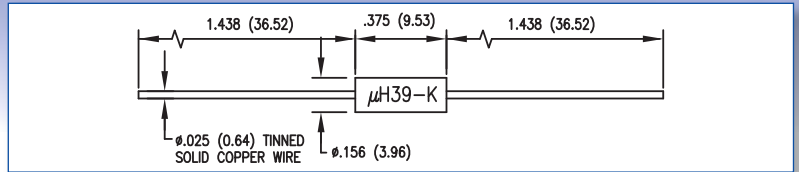
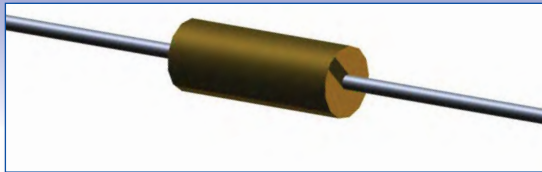

Inductance Tolerance Coded Dash Numbers			
-01	±5%	J	To Order
-02	±10%	K	Standard
-03	±20%	M	To Order

Packaging Code	
-00	Loose
-36	Tape (500 Per Reel)

How to order code

55X - XXXX - XX - XX - XX

Basic Part No. ——— Inductance Code

Packaging
Inductance Tolerance

Basic Part No.	Body Marking Inductance & Tolerance	"Q" Min.	Test Frequency (MHz)	DCR Max. (Ω)	DC Max. (mA)	SRF Min. (MHz)	
551-5169	-01	22nH-K	45	30.0	0.0094	5400	940
	-02	27nH-K	45	30.0	0.011	5000	940
	-03	39nH-K	45	25.0	0.013	4600	850
	-04	56nH-K	45	25.0	0.015	4300	730
	-05	68nH-K	45	25.0	0.018	3900	660
	-06	82nH-K	45	25.0	0.019	3800	620
	-07	μH10-K	45	25.0	0.021	3600	600
550-3640	-01	μH15-K	50	25.0	0.030	2450	525
	-03	μH18-K	45	25.0	0.040	2400	450
	-05	μH22-K	50	25.0	0.055	1810	450
	-07	μH27-K	45	25.0	0.070	1800	390
	-09	μH33-K	45	25.0	0.090	1400	360
	-11	μH39-K	45	25.0	0.100	1410	330
	-13	μH47-K	45	25.0	0.120	1225	310
	-15	μH56-K	50	25.0	0.135	1190	280
	-17	μH68-K	50	25.0	0.150	1100	250
	-19	μH82-K	50	25.0	0.220	900	220
	-21	1μH0-K	50	25.0	0.290	785	200
	-23	1μH2-K	33	7.9	0.42	650	180
	-25	1μH5-K	33	7.9	0.50	600	160
	-27	1μH8-K	33	7.9	0.65	525	150
	-29	2μH2-K	33	7.9	0.95	425	139
	-31	2μH7-K	33	7.9	1.20	385	120
	-33	3μH3-K	33	7.9	2.00	300	110
	-35	3μH9-K	33	7.9	2.30	280	100.0
	-37	4μH7-K	33	7.9	2.60	260	90.0
	-39	5μH6-K	45	7.9	0.32	495	60.0
-41	6μH8-K	50	7.9	0.50	395	55.0	
-43	8μH2-K	50	7.9	0.60	360	50.0	
-45	10μH-K	55	7.9	0.90	290	45.0	
-47	12μH-K	65	2.5	1.10	265	42.0	
-49	15μH-K	65	2.5	1.40	240	40.0	
-51	18μH-K	75	2.5	2.25	195	34.0	
-53	22μH-K	75	2.5	2.50	175	30.0	
-55	27μH-K	60	2.5	2.60	170	25.0	
-57	33μH-K	65	2.5	3.00	165	19.0	
551-5180	-01	39μH-K	60	2.50	2.60	250	14.5
	-02	47μH-K	55	2.50	2.75	247	13.0
	-03	56μH-K	55	2.50	3.00	243	12.0
	-04	68μH-K	55	2.50	3.30	235	11.0
	-05	82μH-K	50	2.50	3.90	224	10.3
	-06	mH10-K	50	2.50	4.50	214	9.5
	-07	mH12-K	65	0.79	5.20	205	8.7
	-08	mH15-K	65	0.79	6.05	187	8.0
	-09	mH18-K	65	0.79	6.75	183	7.0
	-10	mH22-K	65	0.79	7.45	175	6.2
	-11	mH27-K	65	0.79	9.00	160	5.5
	-12	mH33-K	65	0.79	12.5	150	5.0
	-13	mH39-K	65	0.79	14.0	140	4.5
	-14	mH47-K	65	0.79	18.0	123	4.2
	-15	mH56-K	65	0.79	21.0	114	4.1
	-16	mH68-K	65	0.79	25.0	105	3.8
	-17	mH82-K	65	0.79	30.0	96	3.6
	-18	1mH0-K	65	0.79	35.0	89	3.4
	-19	1mH2-K	35	0.25	60.0	60	2.0

Temperature Range: 551-5169 -01 to -07 -55°C to +125°C
 550-3640 -01 to -37 -55°C to +125°C
 550-3640 -39 to -57 -55°C to +105°C
 551-5180 -01 to -19 -55°C to +100°C

For RoHS Compliant add suffix -LF to the part number
 Conforms to BS9751 N001 Pattern B